

YachtSafe Manual Vibration sensor



W100 Vibration sensor



Installation of Vibration sensor

Mount the battery

Release the screws with a cross-headed screwdriver to be able to open up the product and mount the battery. The LED lamp is flashing if the battery is OK.



Technical specifications

Measurements:	72 x 35 x 23 mm
Battery lifetime:	up to 2 years
Battery capacity:	1000 mAh
Distance range (free sight):	approx 150 m
Temperature range:	-30 to 70°C
Sealing:	IP67

Additions or adjustments to this manual can be found at www.yachtsafe.se under the Manuals tab.

iOS instructions

Connect the alarm accessory to the G32 system via the app for iOS or Android:

IMAGE 1 Select Alarm accessories & Relay

IMAGE 2 Add & configure accessories

IMAGE 3 **iOS:** New accessory
Android: Choose alarm accessory

IMAGE 4 Choose the accessory to connect. Enter a name for the accessory and then press Connect and follow the instructions.

iOS: After connection of the accessory, go to the tab Alarm accessories & Relay, press Update in the top right. Choose to activate/ Inactivate the alarm accessory by the button Edit in the top left. Choose your settings and press Save.

Android: After connection of the Alarm Accessory, go to the tab Alarm accessories & Relay, press Update. Choose to activate/inactivate the alarm accessory by the symbol  in the top right (press Edit). Choose your settings and press Save.

Android instructions

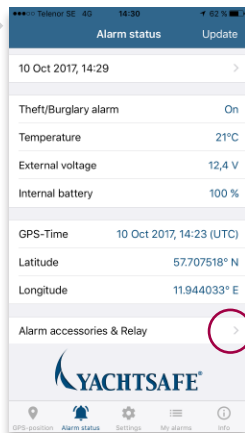

IMAGE 1

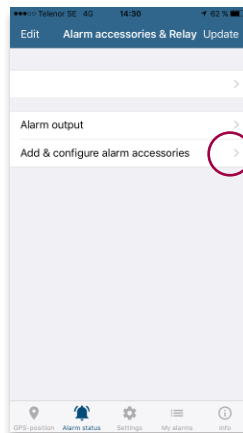

IMAGE 2

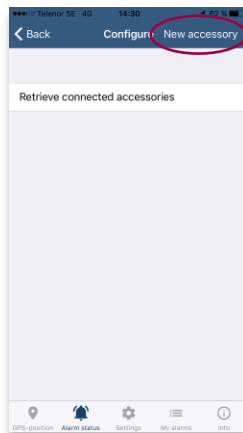

IMAGE 3

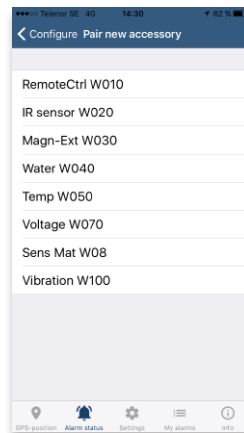
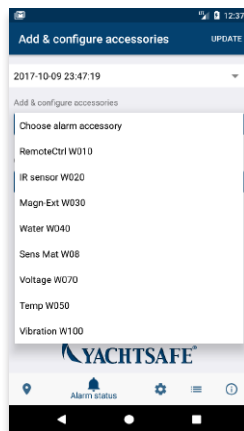
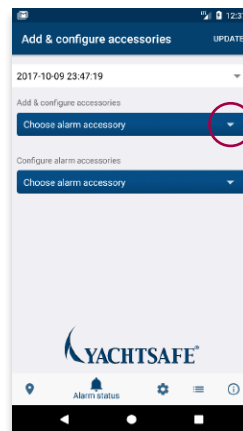
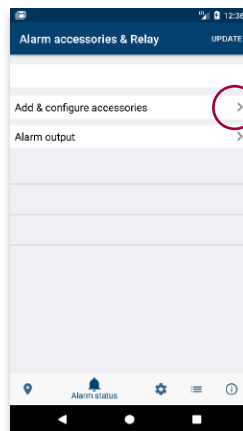
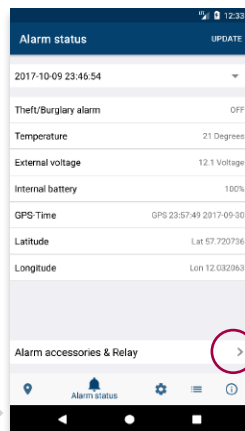

IMAGE 4



Verifying the magnetic alarm connection?

When you have activated, the small LED-light on the accessorie should blink rapidly when the connection is OK. If connection failed it will only turn the LED-light on once for aprox 1-2 sec. If you do not get any response in the app, try again. When activation is successfull you are ready to mount the magnet alarm. Please wait approx 2 minutes before you connect another alarm accessory to the G32 system.

Mounting

Vibrations and chocks make the vibration sensor send an alarm. Note that after the alarm is activated the sensor must be still for 10 seconds before it sends an alarm. The vibration sensor can be mounted on metal materials with help of the magnetic feet (Accessory). It's also possible to mount it with the help of cable ties around cables and other objects. The vibration sensor is waterproof and made for outdoor environment. The signal from the sensor part to the alarm unit will pass through walls and a big variety of materials. However, check the signal before mounting. After the accessory has been connected to the alarm you are able to push the button on the circuit card fast. If the LED light on the circuit board is flashing this means that the distance range is enough. You will receive alarm directly in your phone if the battery in the accessory has to be changed.

To change the level of sensitivity the sensor needs to be opened up. There is a switch on the circuit card with three different positions (Low, medium, high) that you can choose from.

Low:



Medium:



High:



1 2 3



Connection
button